

Flow Measurement

SITRANS F M

Flow sensor MAG 3100 P

Overview



The SITRANS F M MAG 3100 P is designed to meet the most common specifications within chemical and process industries.

Benefits

- DN 15 to DN 300 (½" to 12")
- Short lead time
- Most used flowmeter in the chemical and process industries with PTFE/PFA liner and Hastelloy electrodes
- Excellent chemical resistance
- Full scope of global approvals for hazardous areas:
 - ATEX, FM, CSA, IECEx
 - 24 V and 115/230 V Ex compact and remote
 - intrinsically safe ia analog output
- Comprehensive self-diagnostic for error indication and error logging
- Fully welded construction provides a ruggedness that suits the toughest applications and environments
- Easy commissioning, the SENSORPROM unit automatically updates settings.

Application

The main applications of the SITRANS F M electromagnetic flow sensors can be found in the following fields:

- Chemical industry
- Process industry
- Pulp and paper
- Industrial waste water

Design

- Compact or remote mounting possible
- Easy "plug & play" field changeability of transmitter
- High temperature sensor for applications with temperatures up to 150 °C (302 °F)
- Meets EEC directives: PED, 97/23/EC pressure directive for EN1092-1 flanges, and CRN
- Build-in length according to ISO 13359
- Onsite or factory upgrade to IP68/NEMA 6P of a standard sensor.

Mode of operation

The flow measuring principle is based on Faraday's law of electromagnetic induction according to which the sensor converts the flow into an electrical voltage proportional to the velocity of the flow.

Integration

The complete flowmeter consists of a flow sensor and an associated transmitter MAG 5000, 6000 and 6000 I.

The flexible communication concept USM II simplifies integration and update to a variety of fieldbus systems such as HART, FOUNDATION Fieldbus H1, DeviceNet, PROFIBUS DP and PA, Modbus RTU/RS485.

Pressure/temperature curve to EN (DIN) flanges, material A 105 carbon steel

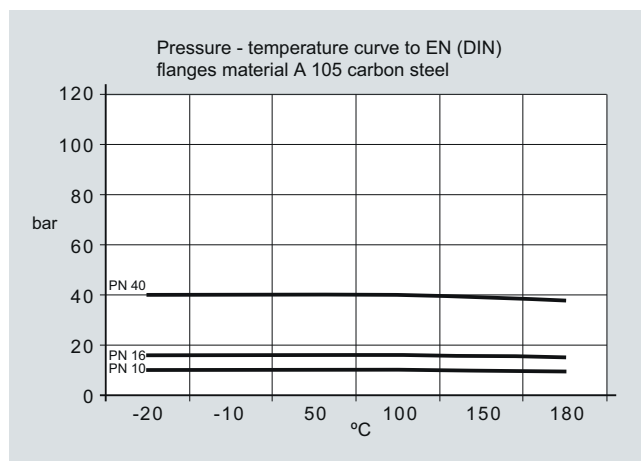

Pressure/temperature curve to ANSI B16.5 flanges

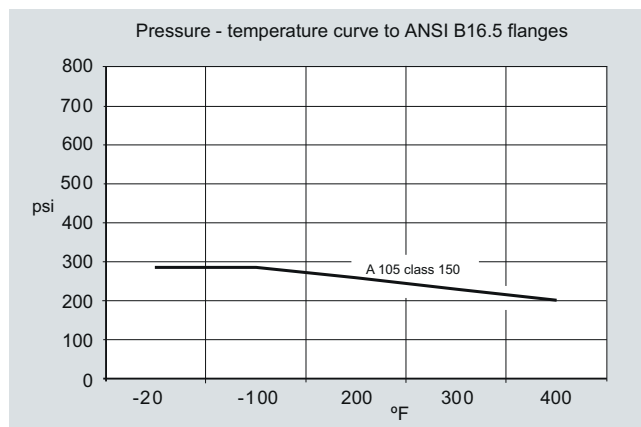

Note: The pressure-temperature curves only assist in the selection of a system. No responsibility is taken for the correctness of the information. For further information on the PED standard and requirements, see page 10/9.

Technical specifications

Product characteristic	Chemical and process industry-oriented (short lead time)
Nominal size	<ul style="list-style-type: none"> • PTFE: DN 15 ... 300 (½" ... 12") • PFA: DN 15 ... 150 (½" ... 6")
Measuring principle	Electromagnetic induction
Excitation frequency (Mains supply: 50 Hz/60 Hz)	<ul style="list-style-type: none"> • DN 15 ... 65 (½" ... 2½"): 12.5 Hz/15 Hz • DN 80 ... 150 (3" ... 6"): 6.25 Hz/7.5 Hz • DN 200 ... 300 (8" ... 12"): 3.125 Hz/3.75 Hz
Process connection	
Flanges	EN 1092-1, raised face ¹⁾ (EN 1092-1, DIN 2501 and BS 4504 have the same mating dimensions) <ul style="list-style-type: none"> • DN 15 ... 50 (½" ... 2"): PN 40 (580 psi) • DN 65 ... 300 (2½" ... 12"): PN 16 (232 psi) • DN 200 ... 300 (8" ... 12"): PN 10 (145 psi) ANSI B16.5 (~BS 1560), raised face <ul style="list-style-type: none"> • ½" ... 12": Class 150 (20 bar (290 psi))
Rated operation conditions	
Ambient temperature (conditions also dependent on liner characteristics)	
• Standard sensor	-40 ... +100 °C (-40 ... +212 °F)
• Ex sensor	-20 ... +60 °C (-4 ... +140 °F)
• With compact transmitter	
- MAG 5000/6000 ²⁾	-20 ... +60 °C (-4 ... +140 °F)
- MAG 6000 I	-20 ... +60 °C (-4 ... +140 °F)
- MAG 6000 I Ex de	-20 ... +60 °C (-4 ... +140 °F)
Operating pressure [abs. bar] (maximum operating pressure decreases with increasing operating temperature and with stainless steel flanges)	<ul style="list-style-type: none"> • PTFE/FEP <ul style="list-style-type: none"> - DN 15 ... 300 (½" ... 12"): 0.3 ... 40 bar (4 ... 580 psi) • PFA <ul style="list-style-type: none"> - DN 15 ... 150 (½" ... 6"): Vacuum 0.02 ... 50 bar (0.29 ... 725 psi)
Enclosure rating	IP67 to EN 60529/NEMA 4X/6, 1 mH ₂ O for 30 min Option: IP68 to EN 60529/NEMA 6P, 10 mH ₂ O cont. (not for Ex)
Pressure drop at 3 m/s	As straight pipe
Test pressure	1.5 x PN (where applicable)
Mechanical load (vibration)	<ul style="list-style-type: none"> • 18 ... 1000 Hz random in x, y, z, directions for 2 hours according to EN 60068-2-36 • Sensor: 3.17 grms • Sensor with compact MAG 5000/6000 mounted transmitter: 3.17 grms • Sensor with compact MAG 6000 I/6000 I Ex mounted transmitter: 1.14 grms
Temperature of medium	<ul style="list-style-type: none"> • PTFE -20 ... +130 °C (-4 ... +266 °F) • PFA -20 ... +150 °C (-4 ... +302 °F)
EMC	2004/108/EC

Design	
Weight	See dimensional drawings
Flange and housing material	Carbon steel ASTM A 105, with corrosion resistant two component epoxy coating (min. 150 μm)
Measuring pipe material	AISI 304/1.4301
Electrode material	PTFE: Hastelloy C276/2.4819 PFA: Hastelloy C22/2.4602
Grounding electrode material	PTFE: No grounding electrodes PFA: Hastelloy
Terminal box (remote version only)	<ul style="list-style-type: none"> • Standard fibre glass reinforced polyamide • Option Stainless steel AISI 316/1.4436 • Ex sensor: Stainless steel AISI 316/1.4436
Cable entries	<ul style="list-style-type: none"> • Remote installation 2 x M20 or 2 x ½" NPT • Compact installation <ul style="list-style-type: none"> - MAG 5000/MAG 6000: 4 x M20 or 4 x ½" NPT - MAG 6000 I: 2 x M25 or 2 x ½" NPT (for supply/output) - MAG 6000 I Ex de: 2 x M25 or 2 x ½" NPT (for supply/output)
Certificates and approvals	
Calibration	
Standard production calibration, calibration report shipped with sensor	Zero-point, 2 x 25 % and 2 x 90 %
Conforms to	PED (All EN1092-1 flanges conforms to PED) – 97/23/EC ³⁾ CRN
Material certificate EN 10204 3.1	On request
Ex approvals	Ex sensor <ul style="list-style-type: none"> • ATEX 2G D: DN 15 ... 300: EEx de ia IIC T3 - T6 • IEC Ex de ia IIC T3-T6 • FM Class I, Div 1 (compact only) • FM Class I, Zone 1 • CSA Class I, Zone 1 Standard sensor <ul style="list-style-type: none"> • FM Class I, Div 2/Zone 2 • CSA Class I, Div 2/Zone 2
Custody transfer (CT) (only together with MAG 5000/6000 CT), order as special	Heat meter pattern approval - OIML R 75 (Denmark) Hot water pattern approval - PTB (Germany) Other media than water - OIML R 117 (Denmark)
¹⁾ DN ≤ 600 type 01 (SORF); DN > 600 type 11 (WNRF)	
²⁾ With compact transmitter MAG 5000 CT/6000 CT -20 ... +50 °C	
³⁾ For further information on the PED standard and requirements, see page 10/9.	

Flow Measurement

SITRANS F M

Flow sensor MAG 3100 P

Selection and Ordering data	Order No.
Sensor SITRANS F M MAG 3100 P (Short delivery time)	7ME6340-
Diameter	
DN 15 (½")	◆ 1 V
DN 25 (1")	◆ 2 D
DN 40 (1½")	◆ 2 R
DN 50 (2")	◆ 2 Y
DN 65 (2½")	◆ 3 F
DN 80 (3")	◆ 3 M
DN 100 (4")	◆ 3 T
DN 125 (5")	◆ 4 B
DN 150 (6")	◆ 4 H
DN 200 (8")	◆ 4 P
DN 250 (10")	◆ 4 V
DN 300 (12")	◆ 5 D
Flange norm and pressure rating	
EN 1092-1	
PN 10 (DN 200 ... 300 (8" ... 12"))	◆ B
PN 16 (DN 65 ... 300 (2½" ... 12"))	◆ C
PN 40 (DN 15 ... 50 (½" ... 2"))	◆ F
ANSI B16.5	
Class 150 (½" ... 12")	◆ J
Flange material	
Carbon steel flanges ASTM A 105	◆ 1
Liner material	
PTFE (130 °C (266 °F))	◆ 3
PFA (150 °C (302 °F)) (DN 15 ... 150 (½" ... 6"))	◆ 7
Electrode material	
Hastelloy C	◆ 2
Hastelloy C incl. grounding electrode, (only PFA)	◆ 6
Transmitter	
Standard sensor for remote transmitter (Order transmitter separately)	◆ A
Ex sensor for remote transmitter (Order transmitter separately)	◆ B
MAG 6000 I, Aluminum, 18 ... 90 V DC, 115 ... 230 V AC	◆ C
MAG 6000 I, Aluminum, 18 ... 30 V DC, Ex	◆ D
MAG 6000 I, Aluminum, 115 ... 230 V AC, Ex	◆ E
MAG 6000, Polyamide, 11 ... 30 V DC/11 ... 24V AC	◆ H
MAG 6000, Polyamide, 115 ... 230 V AC	◆ J
MAG 5000, Polyamide, 11 ... 30 V DC/11 ... 24 V AC	◆ K
MAG 5000, Polyamide, 115 ... 230 V AC	◆ L
Communication	
No communication, add-on possible	◆ A
HART	◆ B
PROFIBUS PA Profile 3 (only MAG 6000/MAG 6000 I)	◆ F
PROFIBUS DP Profile 3 (not for Ex) (only MAG 6000/MAG 6000 I)	◆ G
Modbus RTU/RS 485 (not for Ex) (only MAG 6000/MAG 6000 I)	◆ E
FOUNDATION Fieldbus H1 (only MAG 6000/MAG 6000 I)	◆ J
Cable glands/terminal box	
Metric: Polyamide terminal box or 6000 I compact	◆ 1
½" NPT: Polyamide terminal box or 6000 I compact	◆ 2
Metric SS terminal box (mandatory for stainless steel MAG 6000 transmitter)	◆ 3
½" NPT SS terminal box (mandatory for stainless steel MAG 6000 transmitter)	◆ 4

Selection and Ordering data	Order code
Additional information	
Please add "-Z-" to Order No. and specify Order code(s) and plain text.	
Factory certificate according to EN 10204-2.2	C14
Factory certificate according to EN 10204-2.1	C15
Tag name plate, stainless steel fixed with SS wire (add plain text)	Y17
Tag name plate, plastic (self adhesive)	Y18
Customer-specific converter setup	Y20
Power cable wired (specify cable order no.)	Y40
Sensor for remote transmitter's junction box IP68 with wired cable (specify cable order no.) (not for ATEX)	Y41
Other postproduction requirements (add desired text)	Y99
Additional calibrations	
• Matched pair - (Standard production calibration where sensor and transmitter is calibrated together)	On request¹⁾
• Accredited Siemens Flow Instruments matched pair Calibration acc. to ISO/IEC 17025: 2005	On request¹⁾
• Customer-specified calibration up to 10 points	On request¹⁾
• CT verification and authority seal according to: PTB (Denmark and Germany)	On request¹⁾
• Customer-witnessed calibration Any of above calibration	On request¹⁾

¹⁾ Ordering On request as dedicated information from the customer on the individual sensors is required. Please fill in the calibration form found on pi.khe.siemens.de/index.aspx?Nr=17460 and send together with the order. (Size dependent restriction on maximum flow rates may apply)

Operating instructions for SITRANS F M MAG 3100 P

Description	Order No.
• English	A5E03005599
• German	A5E03086288
• Spanish	A5E03086291
• French	A5E03086290

This device is shipped with a Quick Start guide and a CD containing further SITRANS F literature.

All literature is also available for free at:

<http://www.siemens.com/flowdocumentation>

Please also see www.siemens.com/SITRANSOrdering for practical examples of ordering

MAG 5000/6000 transmitters and sensors are packed in separate boxes, the final assembly takes place during installation at the customer's place. MAG 6000 I/MAG 6000 I ATEX 2G D transmitters and sensors are delivered compact mounted from factory. Communication module will be pre-mounted in the transmitter.

Accessories

Description	Order No.
Potting kit for terminal box of SITRANS F M sensors for IP68/NEMA 6P (not for Ex)	◆ FDK-085U0220



◆ Short lead time (details in PMD)

Please use online Product selector to get latest updates.

Product selector link:

www.pia-selector.automation.siemens.com

Selection and Ordering data

MAG 3100 P Type E grounding and protection ring

1 pc. **AISI 316** grounding and protection rings **type E** for PTFE liners

Type E

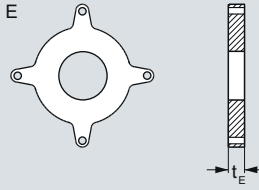

DN	PN 10 Order No.	PN 16 Order No.	PN 40 Order No.	ANSI ¹⁾	Class 150 Order No.
DN 15			FDK-083N8365	1/2"	FDK-083N8365
DN 25			FDK-083N8271	1"	FDK-083N8272
DN 40			FDK-083N8278	1 1/2"	FDK-083N8279
DN 50			FDK-083N8282	2"	FDK-083N8283
DN 65		FDK-083N8285		2 1/2"	FDK-083N8287
DN 80		FDK-083N8289		3"	FDK-083N8291
DN 100		FDK-083N8117		4"	FDK-083N8118
DN 125		FDK-083N8121		5"	FDK-083N8122
DN 150		FDK-083N8125		6"	FDK-083N8126
DN 200	FDK-083N8130	FDK-083N8130		8"	FDK-083N8370
DN 250	FDK-083N8136	FDK-083N8137		10"	FDK-083N8140
DN 300	FDK-083N8144	FDK-083N8145		12"	FDK-083N8148

Protection of PTFE liner use 2 pcs.

Earthing of PTFE lined flowmeter use 1 pc.

Selection and Ordering data

MAG 3100 P type E grounding and protecting ring

1 pc. **Hastelloy C276** grounding and protection ring **type E** for PTFE liners

Type E

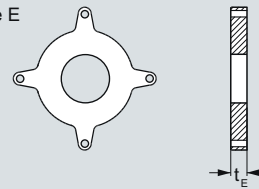

DN	PN 16 Order No.	PN 40 Order No.	Size	ANSI ¹⁾ Class 150 Order No.
DN 15		FDK-083N8487	1/2"	FDK-083N8487
DN 25		FDK-083N8488	1"	FDK-083N8489
DN 40		FDK-083N8490	1 1/2"	FDK-083N8491
DN 50		FDK-083N8492	2"	FDK-083N8493
DN 65	FDK-083N8495		2 1/2"	FDK-083N8497
DN 80	FDK-083N8499		3"	FDK-083N8501
DN 100	FDK-083N8504		4"	FDK-083N8506

¹⁾ For dimensions of MAG 3100 P see table on page 4/85

Flow Measurement

SITRANS F M

Flow sensor MAG 3100 P

Selection and Ordering data

MAG 3100 P Grounding rings: Flat rings

1 pc. **AISI 316** grounding **flat ring** for all liners

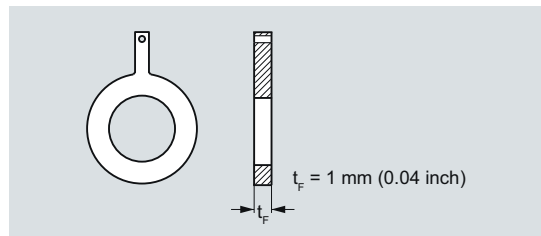

DN	PN 10 Order No.	PN 16 Order No.	PN 40 Order No.	Size	ANSI ¹⁾ Class 150 Order No.
DN 15			A5E01191969	½"	A5E01191968
DN 25			A5E01150880	1"	A5E01150022
DN 40			A5E01191952	1½"	A5E01191961
DN 50			A5E01150918	2"	A5E01151121
DN 65		A5E01191940		2½"	A5E01191962
DN 80		A5E01152876		3"	A5E01152910
DN 100		A5E01158875		4"	A5E01159146
DN 125		A5E01191941		5"	A5E01191963
DN 150		A5E01191943		6"	A5E01191964
DN 200	A5E01191951	A5E01191944		8"	A5E01191965
DN 250	A5E01191950	A5E01191946		10"	A5E01191966
DN 300	A5E01191949	A5E01191947		12"	A5E01191967

Selection and Ordering data

MAG 3100 P Grounding rings: Flat rings

1 pc. **Hastelloy C276** grounding **flat ring**

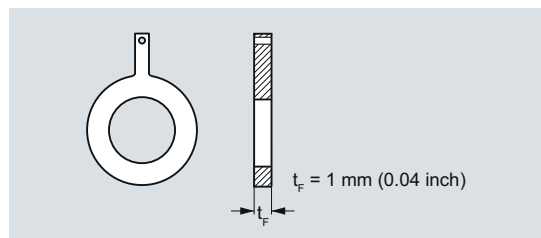

DN	PN 10 Order No.	PN 16 Order No.	PN 40 Order No.	Size	ANSI ¹⁾ Class 150 Order No.
DN 15			A5E01191981	½"	A5E01191989
DN 25			A5E01150882	1"	A5E01150028
DN 40			A5E01191982	1½"	A5E01191990
DN 50			A5E01150922	2"	A5E01151124
DN 65		A5E01191971	A5E01191983	2½"	A5E01191991
DN 80		A5E01152889	A5E01152889	3"	A5E01152913
DN 100		A5E01158886	A5E01159074	4"	A5E01159150
DN 125		A5E01191973	A5E01191984	5"	A5E01191992
DN 150		A5E01191974	A5E01191985	6"	A5E01191993
DN 200	A5E01191978	A5E01191975	A5E01191986	8"	A5E01191994
DN 250	A5E01191979	A5E01191976	A5E01191987	10"	A5E01191995
DN 300	A5E01191980	A5E01191977	A5E01191988	12"	A5E01191996

¹⁾ For dimensions of MAG 3100 P see table on page 4/85

Dimensional drawings

MAG 3100 P sensor with compact or remote transmitter

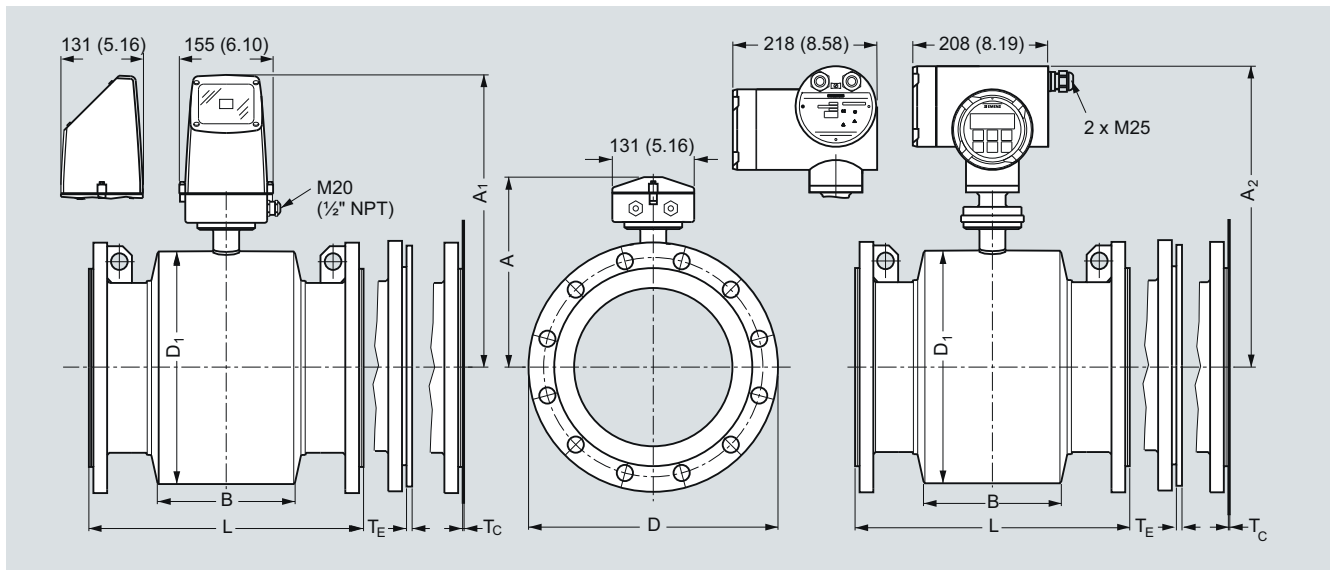

Dimensions in mm (inch)

Metric

DN	A ¹⁾	A ₁ /A ₂ ⁵⁾	B	D ₁	L ²⁾				T _E ³⁾	T _F ³⁾	Wgt. ⁴⁾
					EN 1092-1-201 PN 10	PN 16	PN 40	ANSI 16.5 Class 150			
[mm]	[mm]	[mm]	[mm]	[mm]	[mm]	[mm]	[mm]	[mm]	[mm]	[mm]	[kg]
15	187	341	59	104	-	-	200	200	6	2	4
25	187	341	59	104	-	-	200	200	6	2	5
40	197	351	82	124	-	-	200	200	6	2	8
50	205	359	72	139	-	-	200	200	6	2	9
65	212	369	72	154	200	200/-	200	200	6	2	11
80	222	376	72	174	200	200/-	272 ⁶⁾	272 ⁶⁾	6	2	12
100	242	396	85	214	250	250/-	250	250	6	2	16
125	255	409	85	239	250	250/-	250	250	6	2	19
150	276	500	85	282	300	300/-	300	300	6	2	27
200	304	458	137	338	350	350/-	350	350	8	2	40
250	332	486	157	393	450	450/-	450	450	8	2	60
300	357	511	157	444	500	500/-	500	500	8	2	80

1) 14.5 mm shorter with AISI terminal box (Ex and high temperature version)

2) When earthing flanges are used, the thickness of the earthing flange must be added to the built-in length

3) T_E = Type E grounding ring (Included and factory mounted on high temperature 180 °C PTFE sensor),
T_F = Flat type grounding rings

4) Weights are approx. (for PN 16) without transmitter

5) A₂ is 3 mm shorter than A₁

6) Not according to ISO 13359

- not available

D = Outside diameter of flange, see flange tables

Flow Measurement

SITRANS F M

Flow sensor MAG 3100 P

MAG 3100 P sensor with compact or remote transmitter

Imperial

Size	A ¹⁾	A ₁ /A ₂ ⁵⁾	B	D ₁	L ²⁾				T _C ³⁾	T _E ³⁾	T _F ³⁾	Wgt. ⁴⁾
					EN 1092-1-201			ANSI 16.5				
[inch]	[inch]	[inch]	[inch]	[inch]	PN 10	PN 16	PN 40	Class 150	[inch]	[inch]	[inch]	[lb]
½	7.36	13.4	2.32	4.09	-	-	7.87	7.87	-	0.24	0.08	9
1	7.36	13.4	2.32	4.09	-	-	7.87	7.87	0.05	0.24	0.08	11
1½	7.76	13.8	3.23	4.88	-	-	7.87	7.87	0.05	0.24	0.08	17
2	8.07	14.1	2.83	5.47	-	-	7.87	7.87	0.05	0.24	0.08	20
2½	8.35	14.4	2.83	6.06	7.87	7.87/-	7.87	7.87	0.05	0.24	0.08	24
3	8.74	14.8	2.83	6.85	7.87	7.87/-	10.71 ⁶⁾	10.71 ⁶⁾	0.05	0.24	0.08	26
4	9.53	15.6	3.35	8.43	9.84	9.84/-	9.84	9.84	0.05	0.24	0.08	35
5	10.04	16.1	3.35	9.41	9.84	9.84/-	9.84	9.84	0.05	0.24	0.08	42
6	10.87	16.9	5.39	11.10	11.81	11.81/-	11.81	11.81	0.05	0.24	0.08	60
8	11.97	18.0	5.39	13.31	13.78	13.78/-	13.78	13.78	0.05	0.31	0.08	88
10	13.07	19.1	6.18	15.47	17.72	17.72/-	17.72	17.72	0.05	0.31	0.08	132
12	14.05	20.1	6.18	17.48	19.69	19.69/-	19.69	19.69	0.06	0.31	0.08	176

¹⁾ 0.571 inch shorter with AISI terminal box (Ex and high temperature version)

²⁾ When earthing flanges are used, the thickness of the earthing flange must be added to the built-in length

³⁾ T_C = Type C grounding ring, T_E = Type E grounding ring (Included and factory mounted on high temperature 356 °F PTFE sensor),

T_F = Flat type grounding rings

⁴⁾ Weights are for ANSI 150 without transmitter

⁵⁾ A₂ is 0.06 inch shorter than A₁

⁶⁾ Not according to ISO 13359

- not available

D = Outside diameter of flange, see flange tables